

Samsung Handsets

— technology at your fingertips



SAMSUNG

Handsets to meet every application

The Samsung handset range offers a wide variety of easy-to-use, ergonomic terminals, suitable for use with Samsung communications solutions.



Each handset is designed to maximise the benefits of the system and give each user the appropriate feature set and access levels for their needs, whether that is a simple telephone, headset, portable terminal or a fully featured handset with LCD display and programmable functions.

Selected Samsung 5000 Series handsets are available in either digital or IP-enabled configuration, providing exactly the same features and functionality to the user whether they are connected as traditional keysets, as IP devices on the network infrastructure or remotely via external data connection, such as DSL.



2
#

Innovation on the desktop

By integrating Samsung's state-of-the-art communications technology into the 5000 Series handsets, your desktop can now become a multi-functioning, converged workstation.

With the application of digital and IP technologies Samsung can truly unite communications within any organisation across LANs, WANs and the Internet with shared features and functionality and a common look and feel to the terminal in every user's hands.

Simple and stylish connections

Samsung 5000 Series display handsets feature a 48 character, 2 line scrollable LCD screen to display call and integral system information with context sensitive keys to help users navigate effortlessly through your chosen system's features.

Display handsets also incorporate programmable, soft keys with tri-coloured LED status indicators that can be used for speed dialing, one-touch feature keys and traditional 'lamp and key' working. Optional add-on modules can also be assigned to compatible handsets to provide 64 additional soft keys.

Samsung also provides standard digital and analogue handsets that are a cost-effective alternative for staff who do not require the use of an LCD display, ensuring everyone has their own point of contact and individual extension.

Freedom to Roam

Samsung Mobility Solutions can take your communications beyond the confines of the office environment. Enabling users to take their workstation wherever they want to go, Samsung offers your staff

complete freedom to work anywhere and still be in total control of their voice and data communications.

Samsung Mobility Solutions can vastly improve working efficiency and reduce ongoing communication costs, for example in multi-site, warehousing and hot-desking environments or where mobile phones are regularly used in the office.



Samsung 5000 series handsets provide access to a host of features, depending on which handset you choose:



209:JANE KELLY
FRI 23 Sep 02:54

Idle display shows extension, name, date & time.

203:BUSY
CBK MSG CAMP

This extension is calling extension 203 which is busy.

CAMP ON TO 203
WAIT FOR ANSWER

Handset has confirmed a camp-on to extension 203.

01712345689
TRANSFER FM 201

This incoming call is a transfer from extension 201.

526:JIM MORGAN
DIAL VIEW EXIT

Directory dialing – at the touch of a button.

JOHN SMITHSON
27/TELESALES

This display shows who is calling and who they have called.

Context sensitive keys

The integral LCD display of Samsung 5000 series handsets allows users to fully benefit from the power of the system, using the context sensitive keys. The text on the LCD display shows exactly which functions are available, dependent upon the status of the call you are currently handling. For example if a call is on hold or being transferred to another extension, the display shows the options which are available. When making a call, the system's integral telephone directory also allows you to scroll to the required name, and by using the soft keys, automatically dial the number.

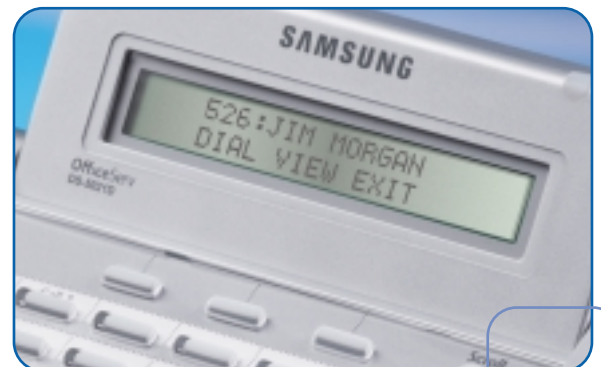

Add-on module

The 5000 series add-on module increases the capability of compatible keyphones. The 64 additional buttons on each module can be used as programmable, speed dial or feature keys, making it an ideal solution for receptionists and call centre staff.

Coloured light indication

The tri-coloured LED lights allow you to track calls being made on the system, both from your own handset and from others. Green indicates your calls, red indicates other system calls, while amber shows recalls.



Appointment reminder

Handsets programmed with an alarm key can be used to remind you of meetings and appointments, with display phones also capable of showing a programmed message when the alarm rings.

Directory dialling

Display handsets allow the user to view, store and dial frequently used numbers, programmed into the system. These directories can be shared between system users, or held within your own personal phone book.



Multi-level screens with up to 99 busy lamp fields.

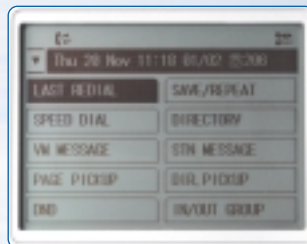

Feature menu provides access to popular phone features.

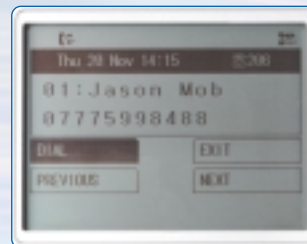

Directory dialling with simple feature selection.

Redialling

Three types of redialling are available:

- auto retry reserves an outside line, automatically redialling the required number up to the pre-programmed limit (network dependent)
- last number redial saves the last dialled number for trying again using the redial button
- save number stores the dialled number for recall after other calls have been made.

Call forwarding

Handsets can be programmed so that if your extension is engaged or you are not available, calls are forwarded to another destination, either internal or external, including a mobile or home number.

Call pick up

Using the call pick up facility, it is possible to programme the system so that users are able to answer each other's calls – ideal for open plan offices or group working.



Headsets – hands free working

Samsung's handset range is also compatible with industry standard headsets, making them an ideal solution for receptionists or call centre working.



On hook dialling

Calls can be made without lifting the handset, with the option of using the keyphone's integral microphone or the handset when the call is answered.

Call waiting alert

Have you ever lost or forgotten an important call? Samsung handsets can indicate with a ring tone and flashing LED that a call is waiting when you are already on another call.

Daughter boards – easily add handsets, fax machines or modems

If you want to add a fax machine, modem or an additional handset, even a cordless phone, to an existing Samsung keyphone – no problem. Thanks to the optional daughter board, the additional device operates completely independently. It even has its own extension number so you can send and receive faxes & e-mails, or connect to the internet, whilst still making calls.

Integral paging – paging facilities for all users

Samsung systems provide an integral paging system which can be tailored to suit the needs of each user, with functionality for internal and external paging from all handsets.

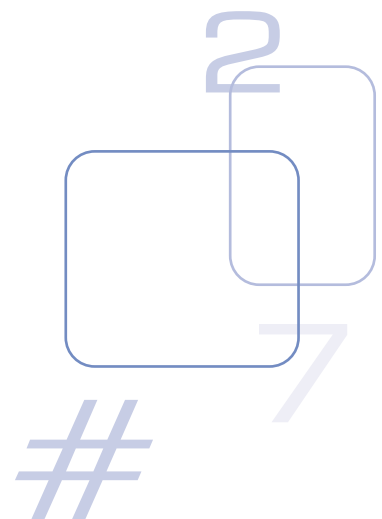

Enhanced usability with Samsung OfficeServ handsets

The Navigation keys available with selected Samsung 5000 series handsets are a main portal through which you can interact with, and navigate through, the system and its features.

Developed using the same design philosophy as Samsung's market leading mobile technology the navigation keys offer simpler usability and faster access to the power of Samsung OfficeServ solutions.



Executive handset, exclusive features

For users of the 5000 Series Executive 12 Button handsets with large, multi-level LCD screen the navigation keys are the instrument for accessing and manoeuvring through the enhanced and exclusive user features the handset provides, such as the:

- Personal organiser
- Text Messaging tool
- Extension configuration
- Ring tone set up
- Personal Phonebook.

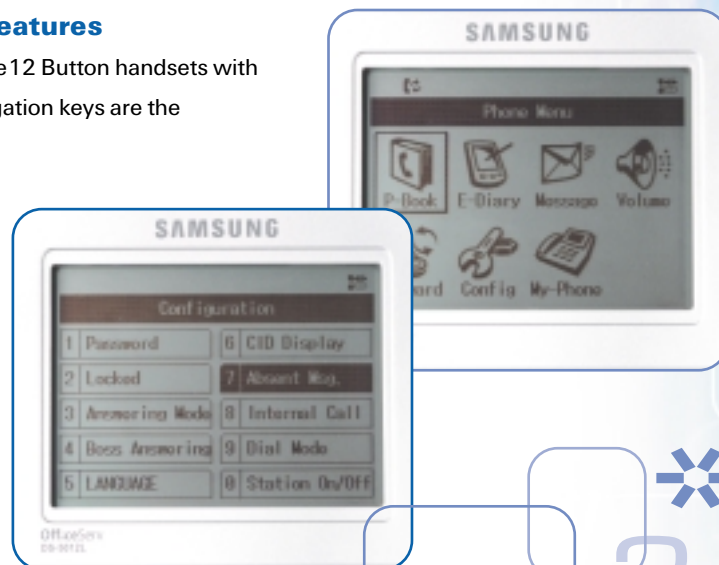

Take control of your communications

The Menu button within the Navigation keys of Standard display handsets takes you into the heart of your user options, through which you can operate and employ the most popular system features, including:

- Personal Speed Dialing
- System Directories
- Call Forward Settings
- Outgoing and Incoming Call Logs
- Personal Alarms.

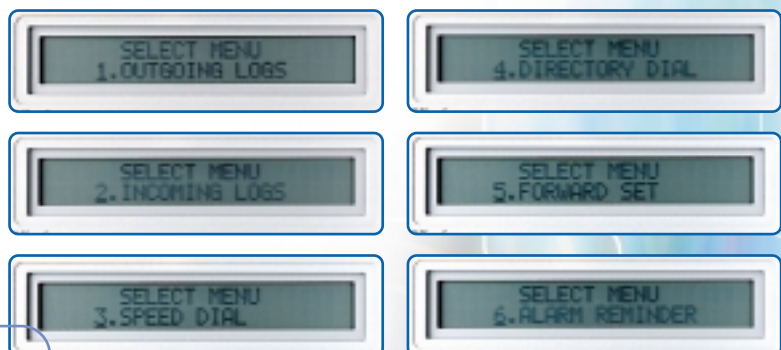

A Samsung DigitAll Revolution

Samsung Telecoms is a division of Samsung Electronics – a global leader in the manufacture and supply of innovative electronics solutions – which in turn is part of the Samsung Group, one of the world's largest companies with global turnover exceeding \$100 billion and more than 170,000 employees.

With a proven pedigree in the manufacture of electronics for commercial and domestic applications, an annual R&D budget of over \$2 billion, and 63,000 staff committed to the development of fixed and wireless communications, Samsung is at the forefront of delivering converged voice and data technologies including Voice over IP, WAN integration and SIP.

Samsung Electronics' core strategy continues to be to maintain leadership in the digital convergence revolution with the mission to bring innovation and digital technology to all products in ways that will make life easier, richer, and more enjoyable for all generations and all customers. This philosophy is known as Samsung DigitAll and everyone's invited to join us in achieving this ambitious goal.

Samsung's expertise in communications and digital technology, combined with a strong commitment to international sport, has made the group a Worldwide Olympic Partner – providing state-of-the-art equipment and playing a vital role in the Olympic experience of billions of people across the globe.

With this backing, Samsung Telecoms is perfectly placed to exploit the convergence of telephony and IT services, and provide organisations with cutting-edge communications solutions.



WORLDWIDE OLYMPIC PARTNER

Samsung Telecoms (U.K.) Limited,
Brookside Business Park,
Greengate,
Middleton,
Manchester M24 1GS
Tel: 0161 655 1100
Fax: 0161 655 1166
www.samsung-telecoms.co.uk
email:marketing@samsung-telecoms.co.uk

SAMSUNG DigitAll
everyone's invited™

The information contained in this document is correct at time of going to press and is subject to change in the interests of product development. It is of a general nature only and may not be specific to your intended use of the products. No guarantee of the products' performance can be given when used with other hardware or software specifications. Please check handsets functionality and compatibility with your equipment or software supplier. This notice does not affect your statutory rights.

Handsets/D/0404